

shelved[®]

Framework

PLEASE READ

These assembly instructions are designed as a guide to assist in the assembly of our modular system. As configurations of the range vary greatly, the instructions are generic in their approach and teach the principles of construction rather than providing layout specific, step-by-step instructions.

Instructional videos, downloadable versions of assembly instructions and FAQs can be found on our website, <https://www.shelved.co.uk/pages/assembly>.



PLEASE NOTE:

- Shelved accepts no responsibility for any damage caused by wall fixing our furniture.
- We will not accept liability for the system being installed against walls of poor condition or the use of unsuitable fixings to suit the wall type.
- All furniture over 90cm high **MUST** be wall fixed to prevent tip-over accidents.

Warning!



All furniture over 90cm tall **MUST** be securely fastened to a wall to prevent tip-over accidents.

When dressing your shelving please give consideration to the placement of heavy items to avoid accidents. Where possible position these as low as possible. Never let children (or unsupervised adults) climb or hang on furniture.

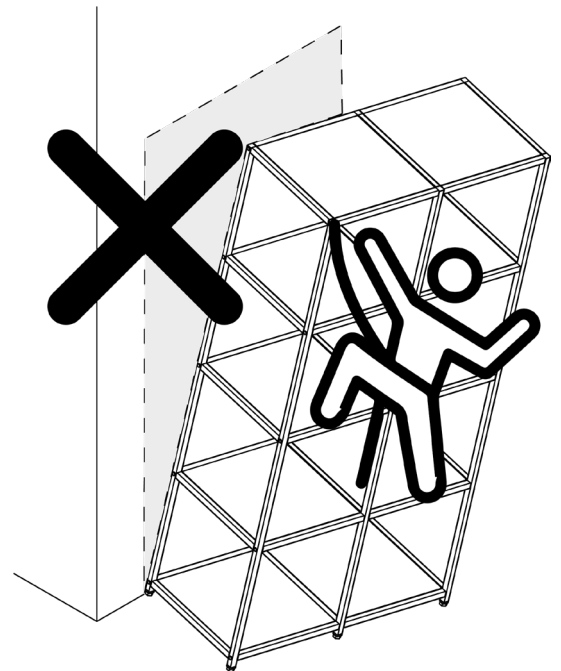
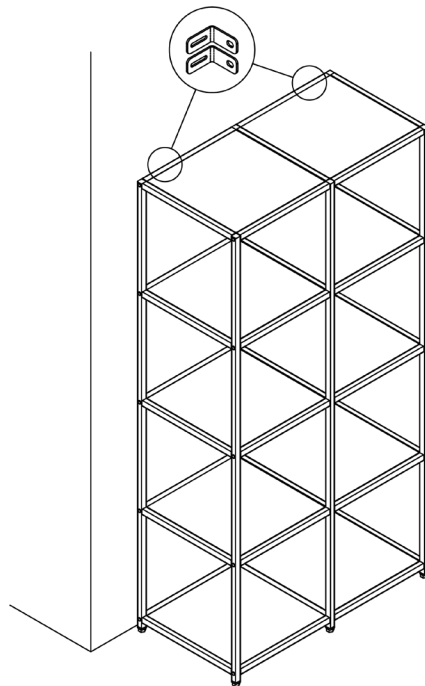

What you will need

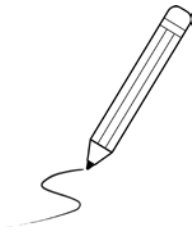

Pencil



Drill



Spirit Level



Screwdriver



20mm Spanner

Where possible we recommend building the framework for your system with the product laid on the floor. Ideally on a soft surface. This makes managing the separate parts considerably easier.

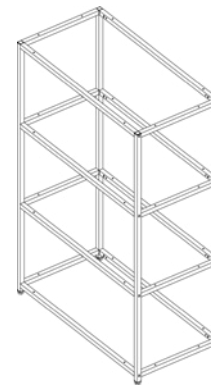
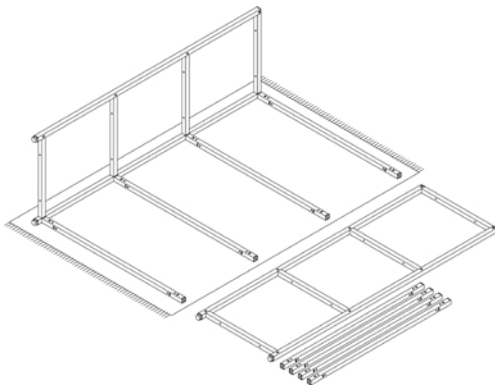

Once you have a stable structure, generally consisting of two or more ladders, the product can be stood upright and added to sequentially.

Part Identification - Hardware

See fittings kit list for quantities

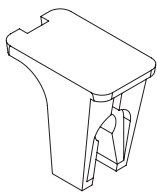

Pin
Clip

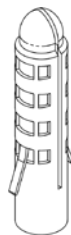

Rawl
Plug

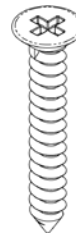

1 1/4"
Woodscrew

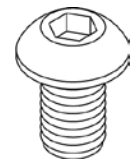

M6x10mm
Bolt

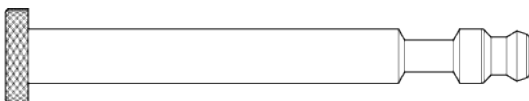

End Pin (scale 1:1)
SH-PIN-END-BRSS/BLCK
Finished in Brass or Black



Inter Pin (scale 1:1)
SH-PIN-INT
Finished in Bright Silver



End Pin (scale 1:1)
SH-PIN-END
Finished in Black ONLY
(NOTE: This pin is only used when placed
next to a panel, cubby or cupboard)

Part Identification - Framework

Cross Rails

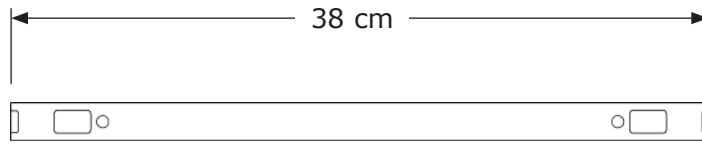

Cross Rail 400
SH-RAIL-04

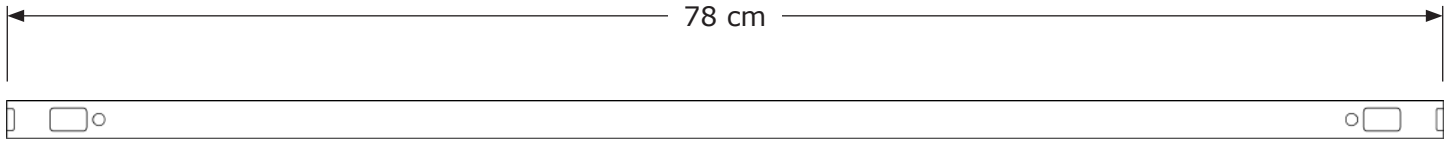

Cross Rail 800
SH-RAIL-08

Bridging Ladders

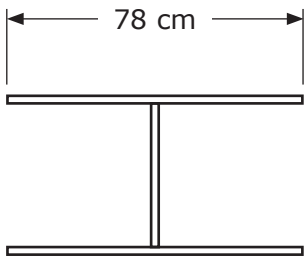

800 Bridging Ladder
SH-BRI-LAD-08

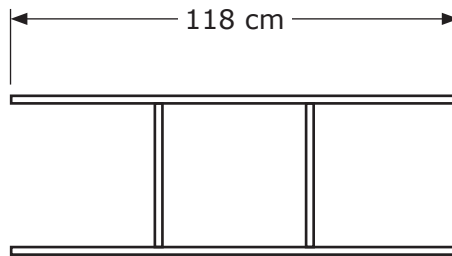

1200 Bridging Ladder
SH-BRI-LAD-12

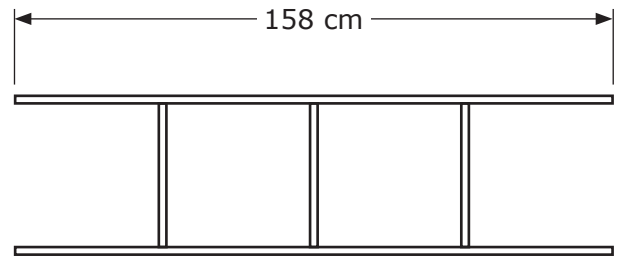

1600 Bridging Ladder
SH-BRI-LAD-16

Ladders

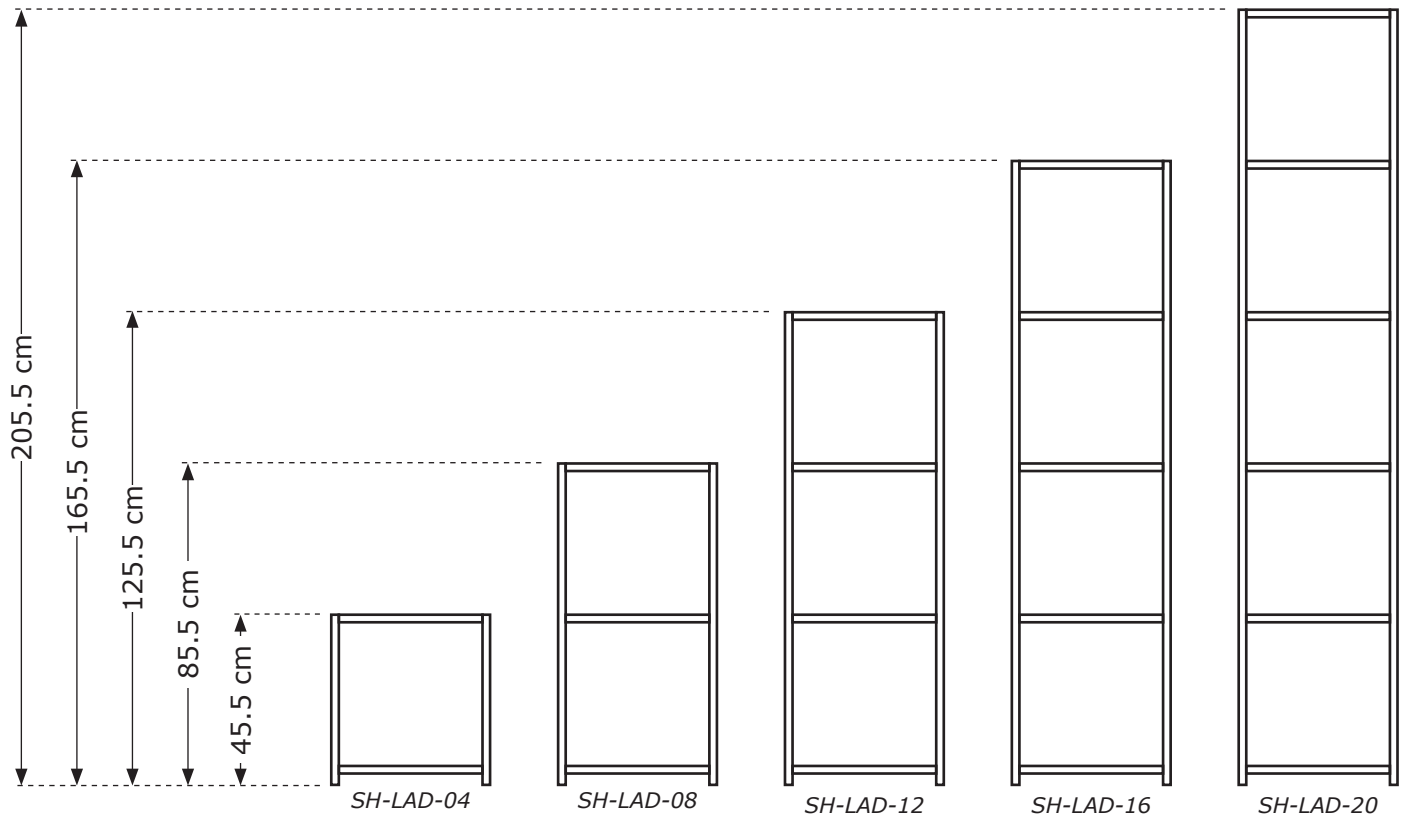

Ladder Extensions

Ladder extensions are designed to sit on top of the standard ladders to extend their height. A ladder extension on top of a 165.5cm ladder (SH-LAD-16) will give an overall height if 245.5cm.

- First remove the bungs from the top of the SH-LAD-16. These should be easy to remove, if for any reason they 'stick' use an allen key or screwdriver to push them out the through the hole n the ladder.
- Then insert the Ladder extension into the top of the ladder, ensuring the protruding steel bars slot inside the tubes of the ladder. You can use the new, taller ladder to build your configuration.

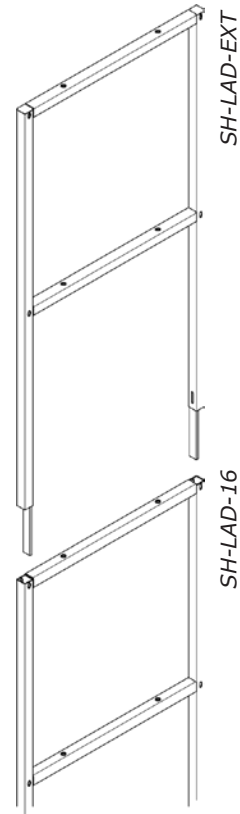
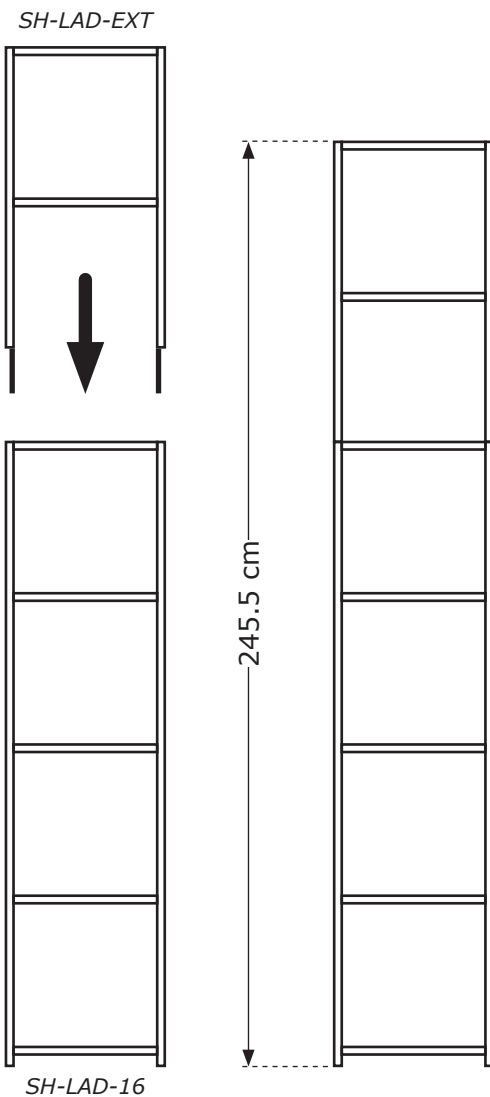
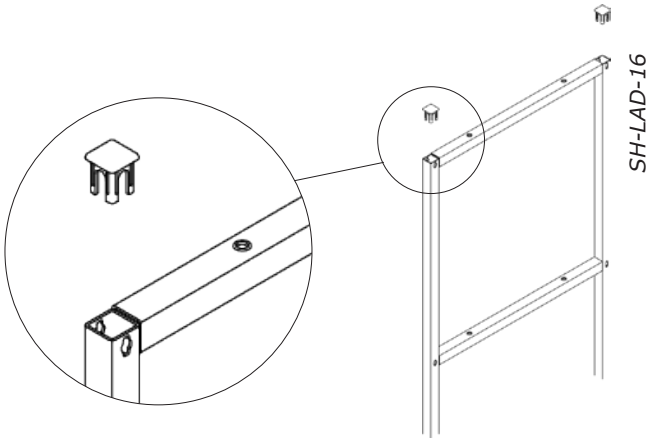

Pin Locations - End Pins

1.1

- End pins (SH-END-PIN-BRSS/BLCK) are used to connect a cross rail to a ladder or bridging ladder.
- These pins are finished in either BRASS or BLACK and have a knurled head.
- They are used to both start and terminate runs of rails.

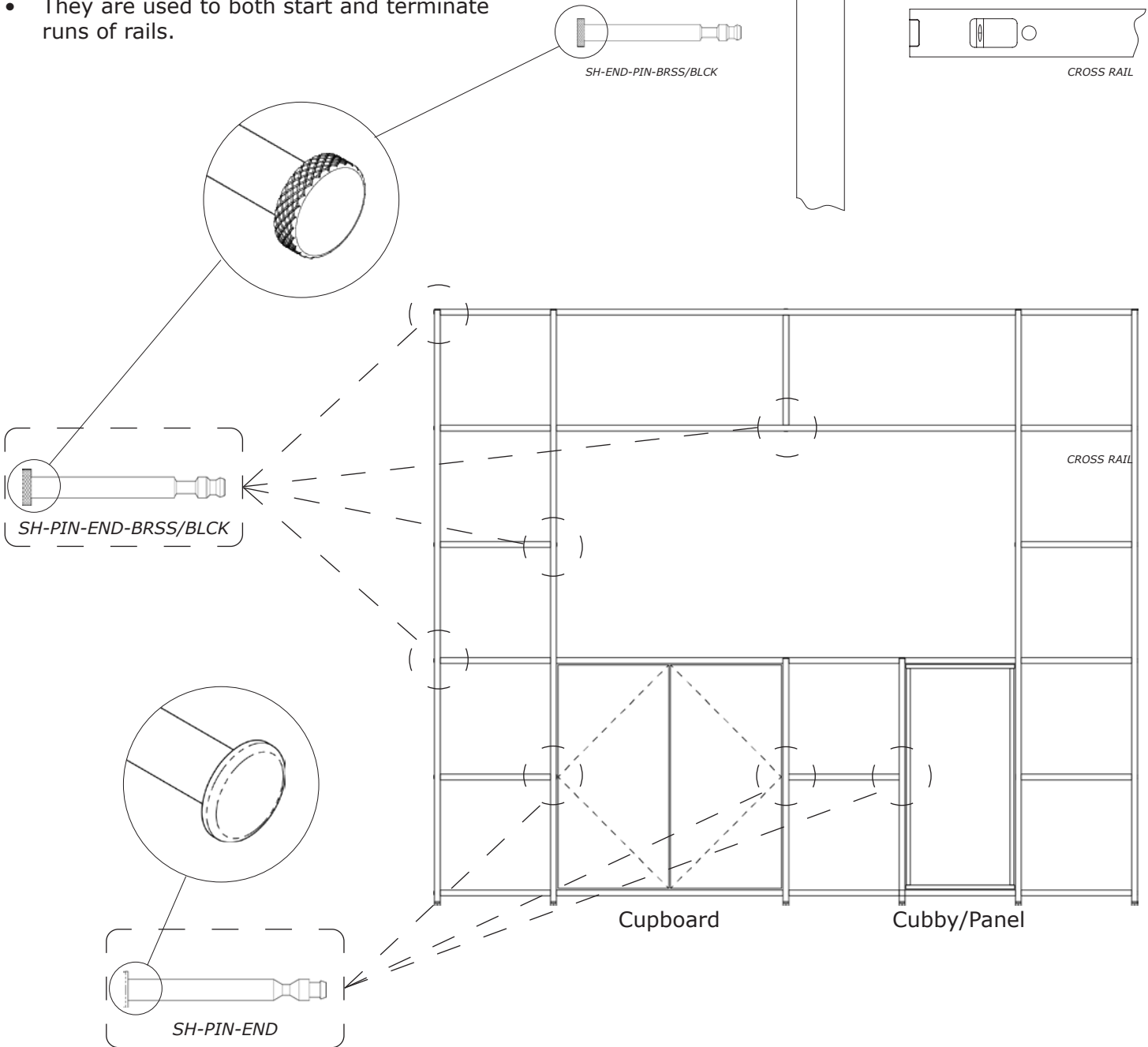

- End pins (SH-END-PIN) are used to connect a cross rail to a ladder or bridging ladder when the head of a pin sits next to a panel, cubby or a cupboard.
- These pins are finished in BLACK only and have a small smooth head.
- They are used to terminate runs of rails when next to a panel, cubby or cupboard.
- As the head of this pin is smaller, it allows the panels, cubbies and cupboard panels to clear the head of the pin without clashing.

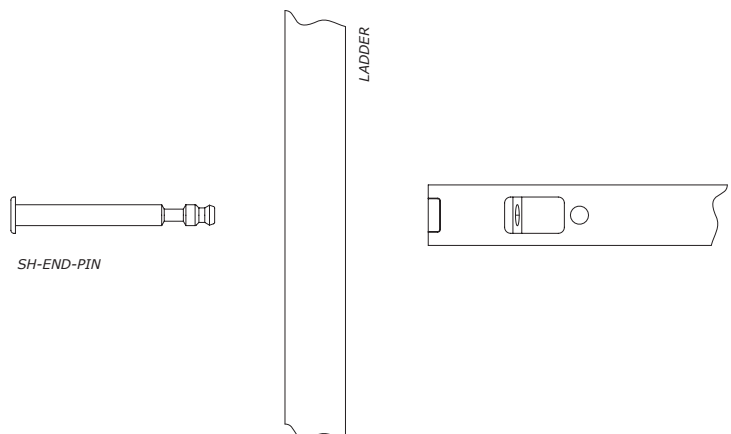

Pin Locations - Intermediate Pins

1.2

- Intermediate pins (SH-INT-PIN) are used to connect cross rails either side of a ladder.
- They are used within continuous runs of cross rails.

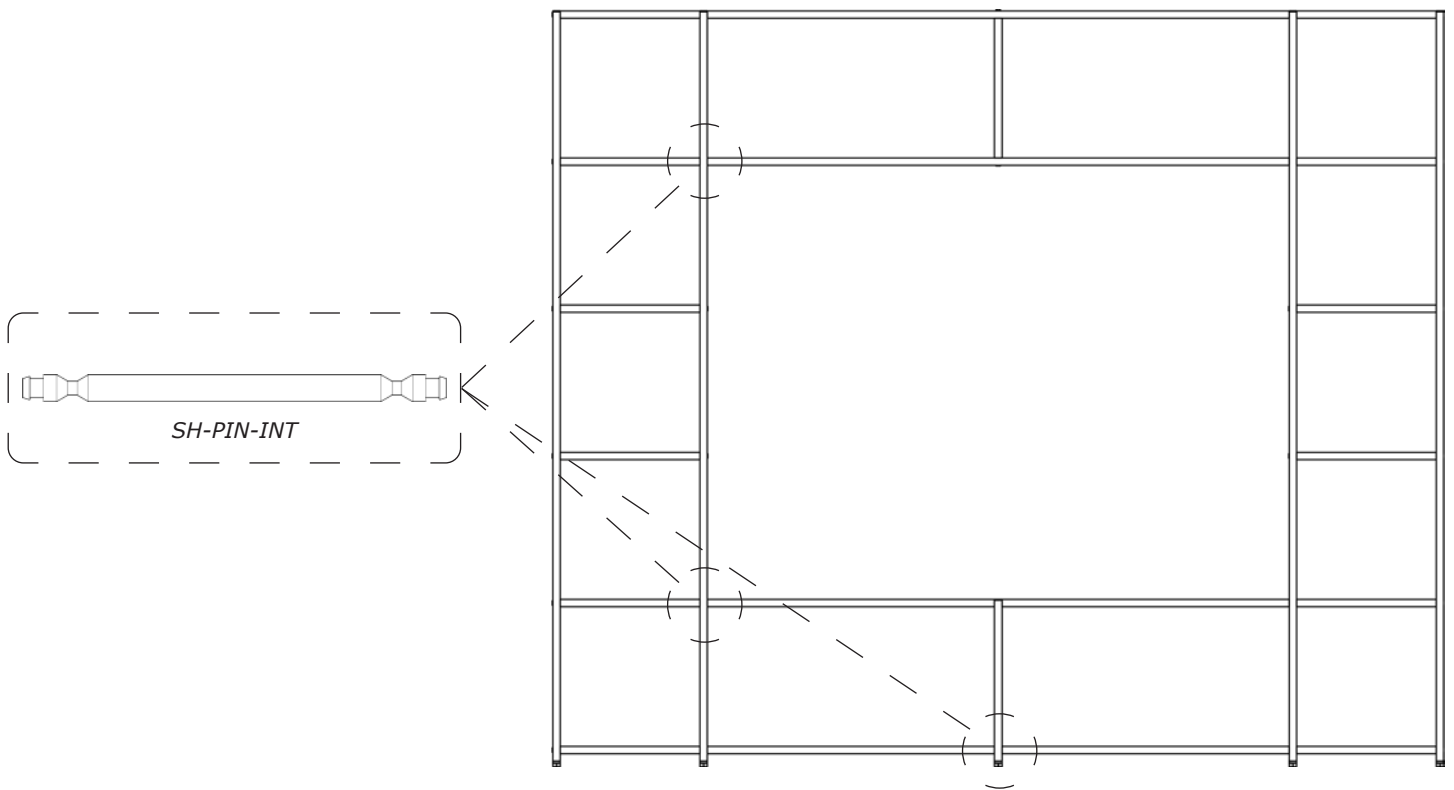
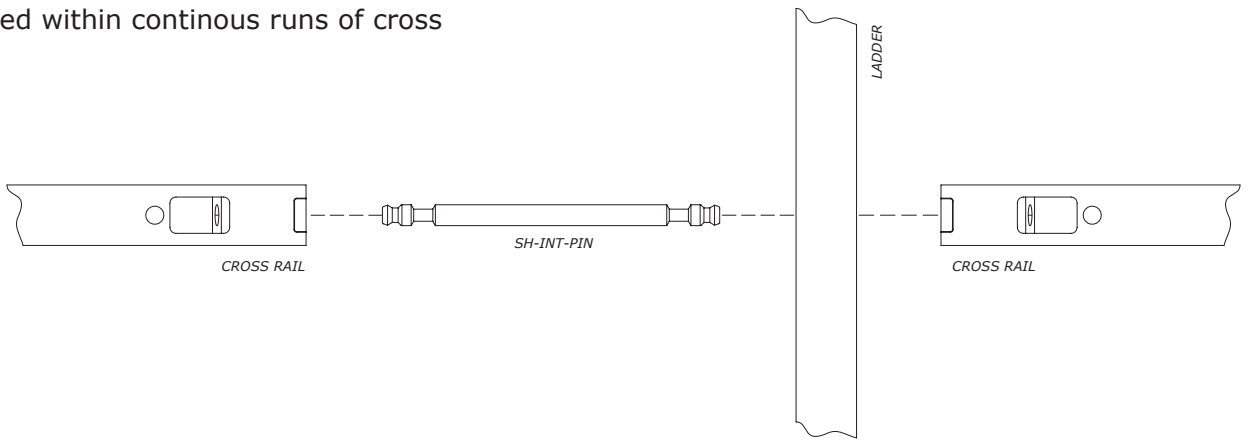

End Pins

2.1

- CHECK RAIL ORIENTATION
- Refer to configuration drawing for rail placement
- Push SH-END-PIN-BRSS/BLCK through the hole in the ladder and into corresponding cross rail until you hear/feel a 'CLICK!'.

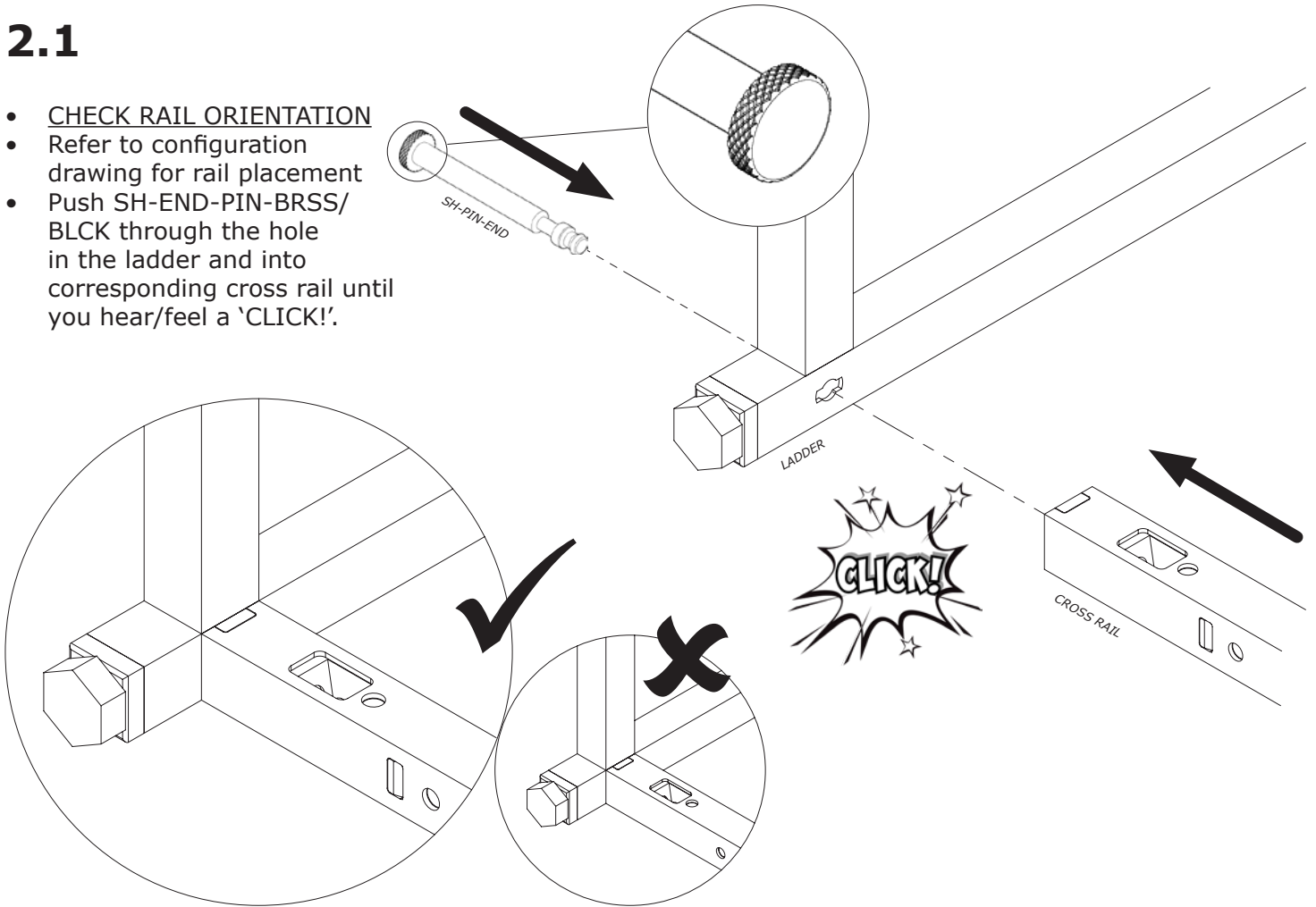

2.2

- Push the Pin Clip into the hole in the cross rail and click.
- Repeat as necessary for additional rails and end pins.

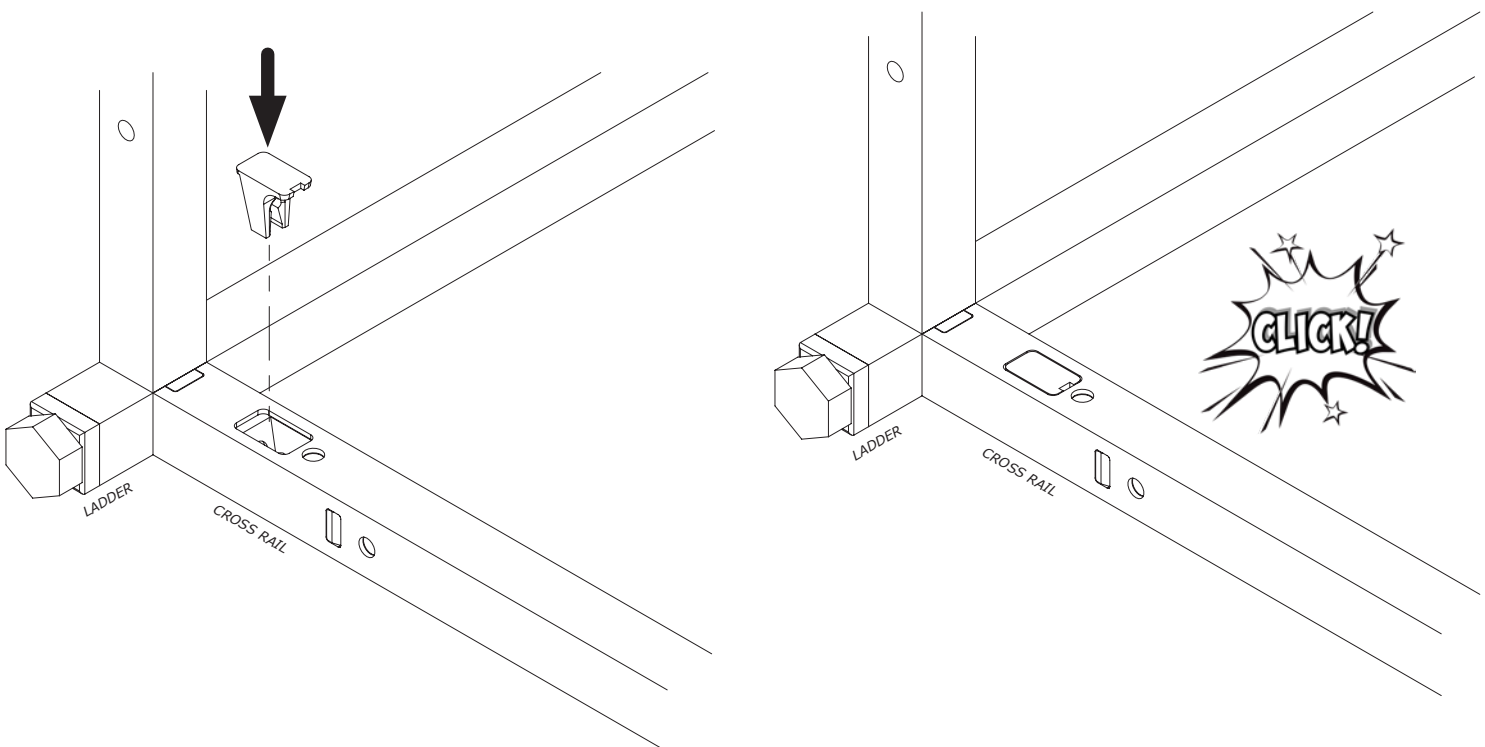

Intermediate Pins

3.1

- CHECK RAIL ORIENTATION
- Refer to configuration drawing for rail placement
- Push SH-PIN-INT through the hole in the ladder and into corresponding cross rail until you hear/feel a 'CLICK!'.

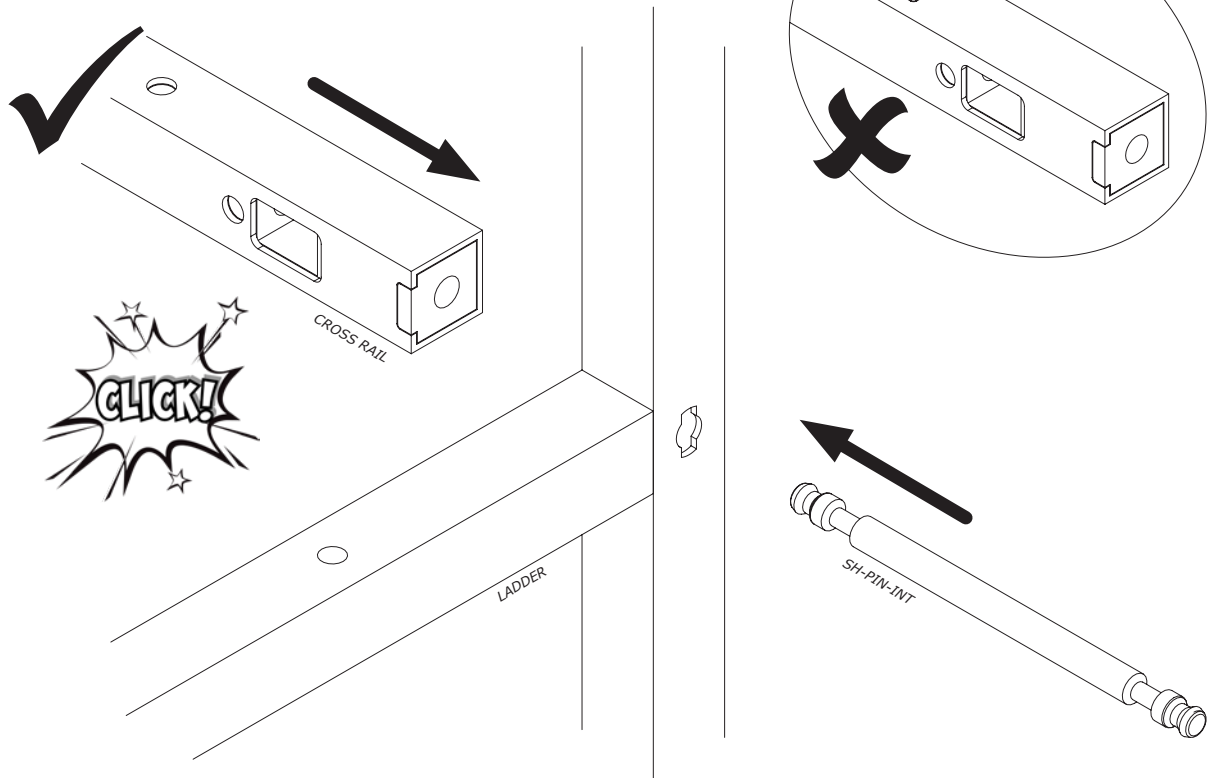

3.2

- CHECK RAIL ORIENTATION
- Refer to configuration drawing for rail placement
- Push adjoining cross rail onto SH-PIN-INT until you hear/feel a 'CLICK!'.

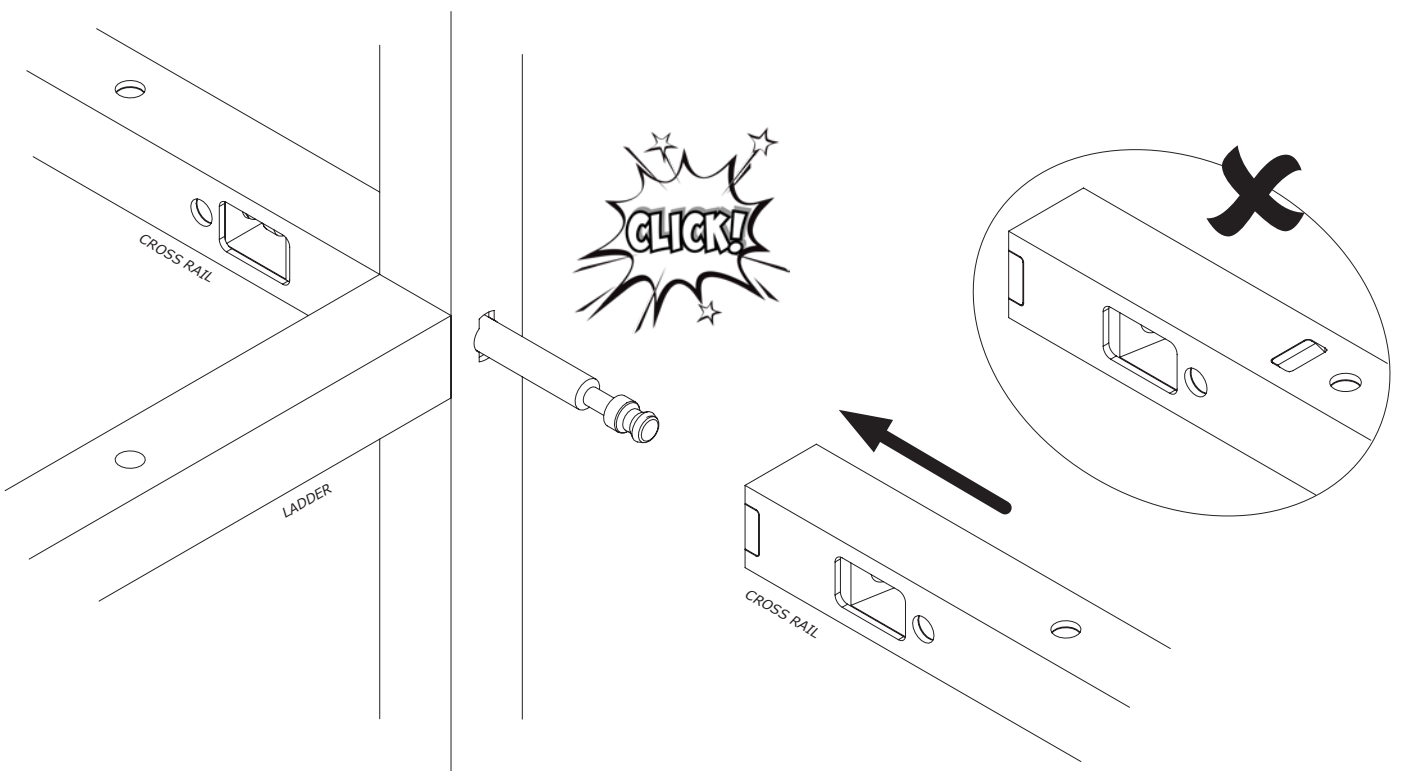

3.3

- Push the pin clip into the hole, please note the orientation of the pin clip.
- Repeat as necessary for additional rails and intermediate pins.

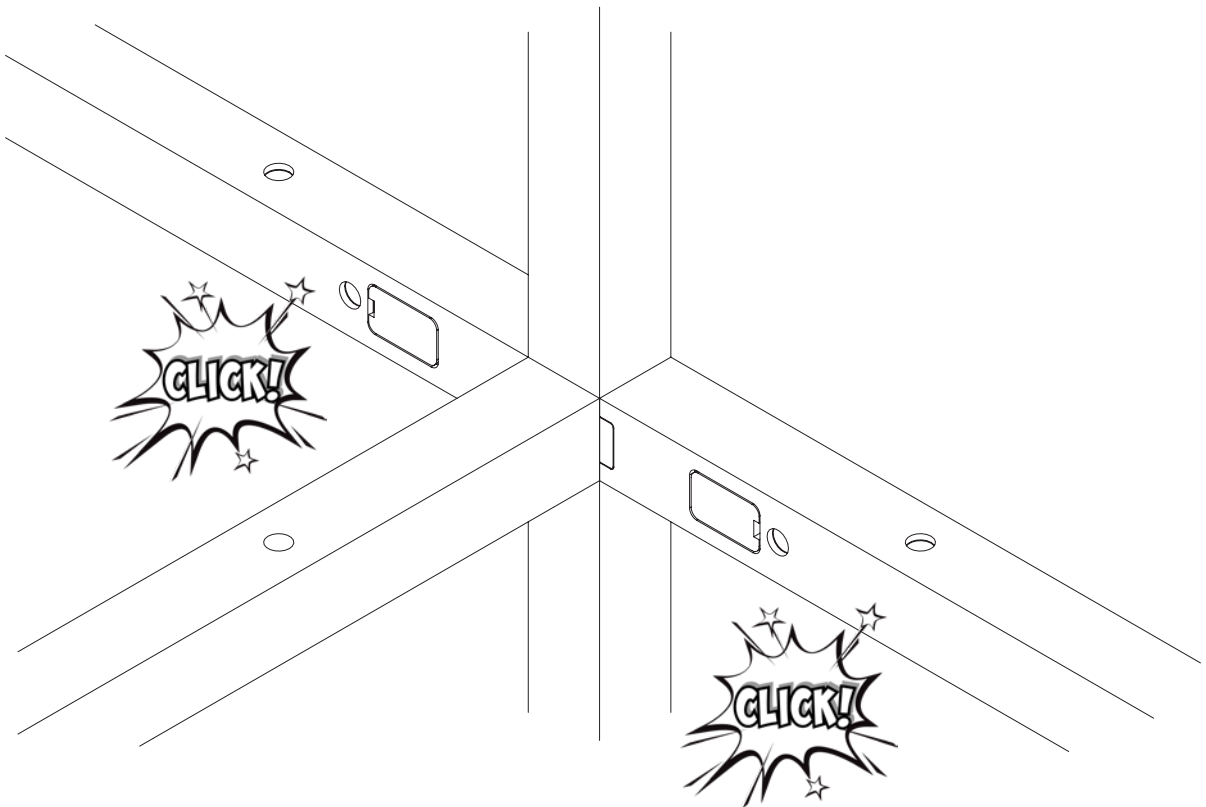
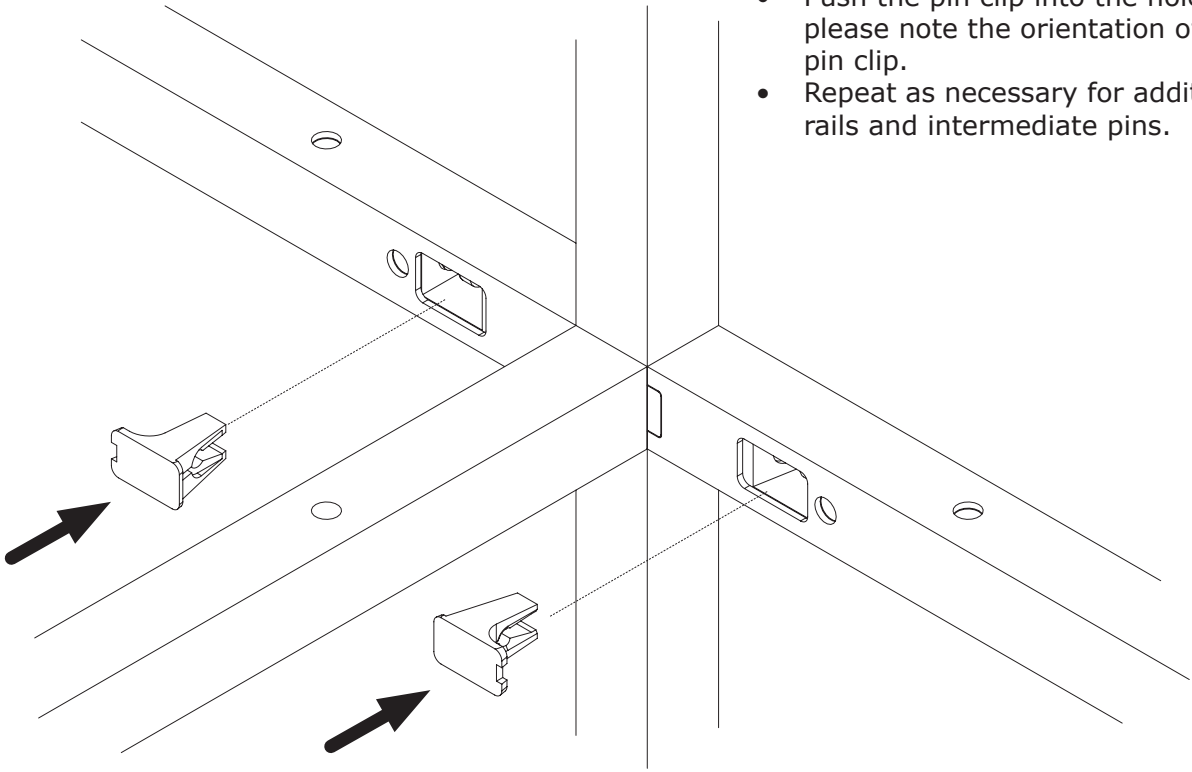

Bridging Ladders

4.1

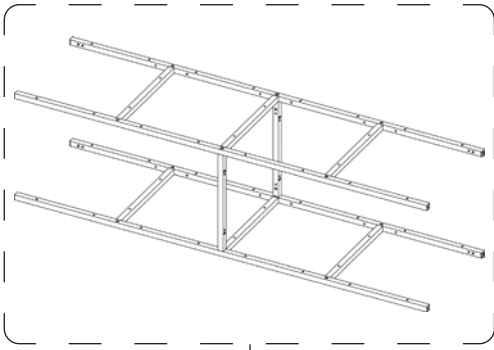

Refer to configuration drawing for bridging ladder and rail configuration.

Build supporting framework first!

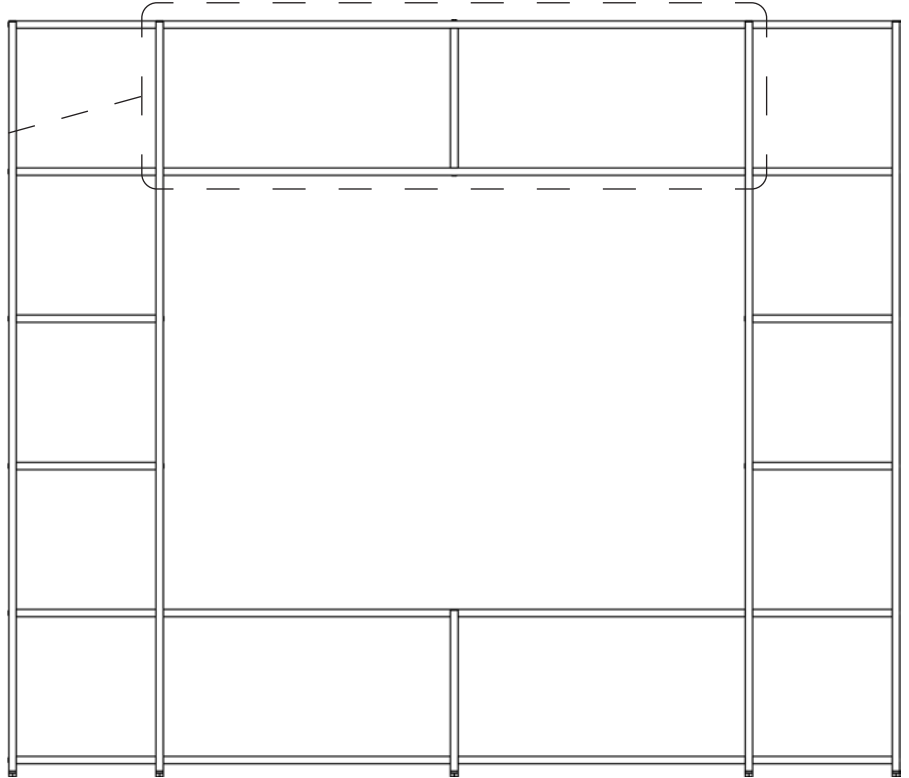
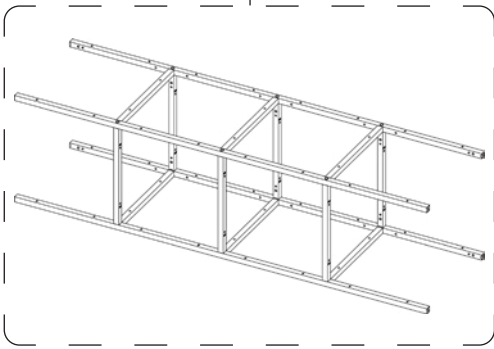

4.2

- Sub-assemble bridging ladder and cross rail assembly.
- Cross rails are used vertically.
- CHECK RAIL ORIENTATION
- Push SH-PIN-END through the hole in the ladder and into corresponding cross rail until you hear/feel a 'CLICK!' then insert the pin clip until you hear/feel a 'CLICK'
- Repeat for additional rails.

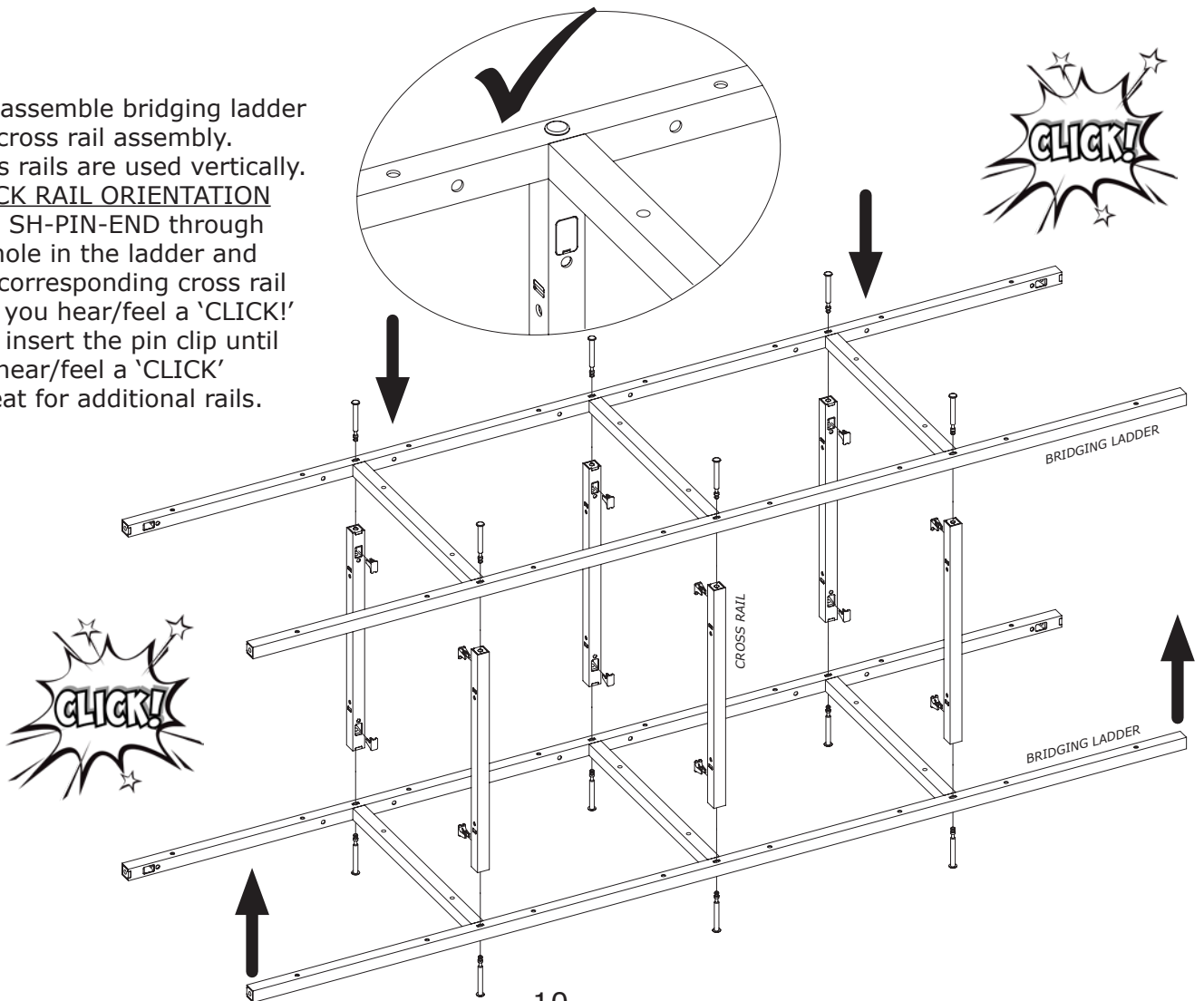

4.3

- Push the pin clip into the hole until you hear/feel a 'CLICK'.
- Repeat as necessary for additional rails and pins.

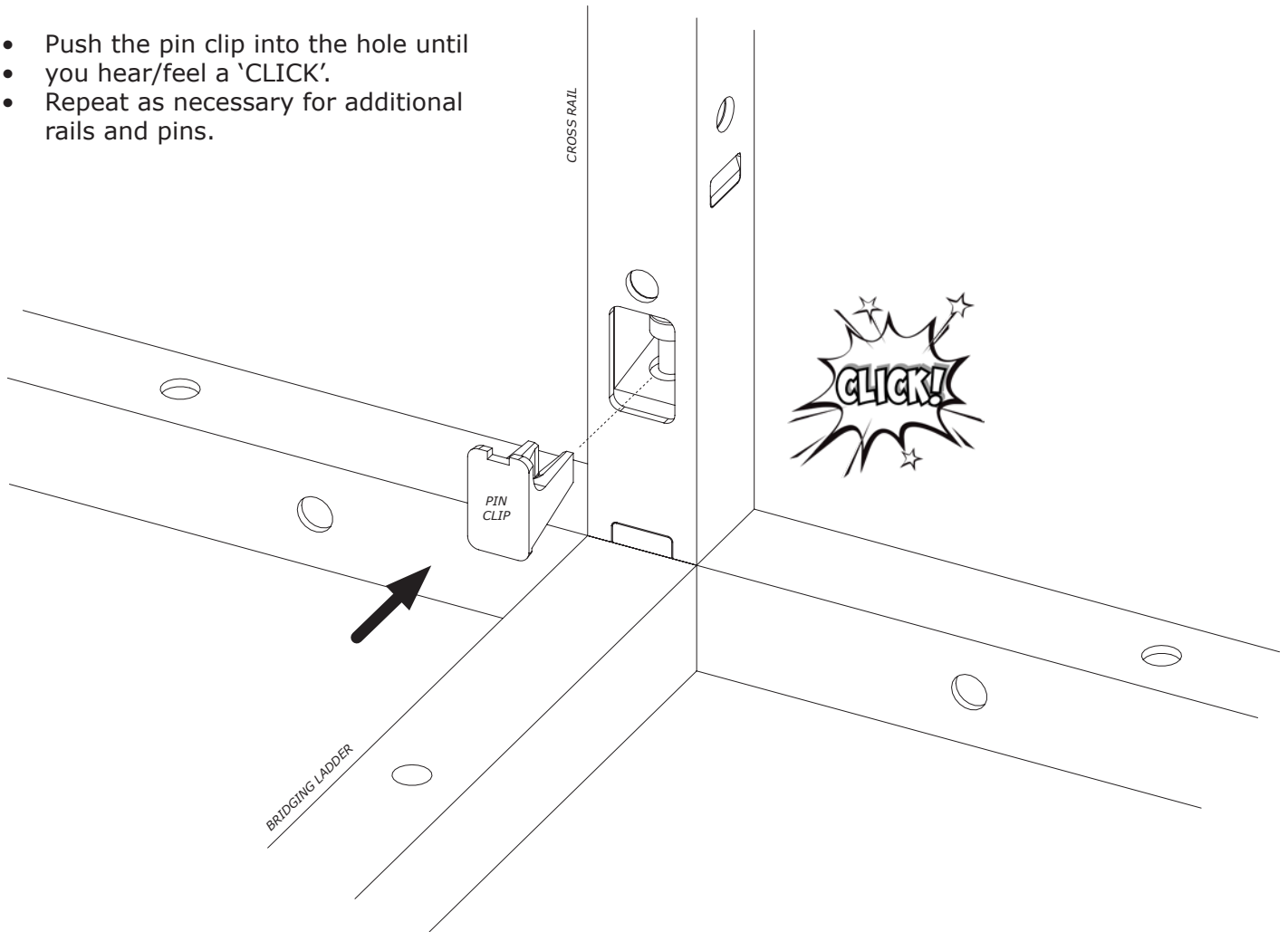

4.4

- If space allows this step should be performed with the framework lying on the floor.
- Grab a friend!
- Line up the ladders of the pre-assembled bridging ladder with the protruding Intermediate Pins (SH-PIN-INT)
- Push assembly onto pins until you hear/feel a 'CLICK!'.

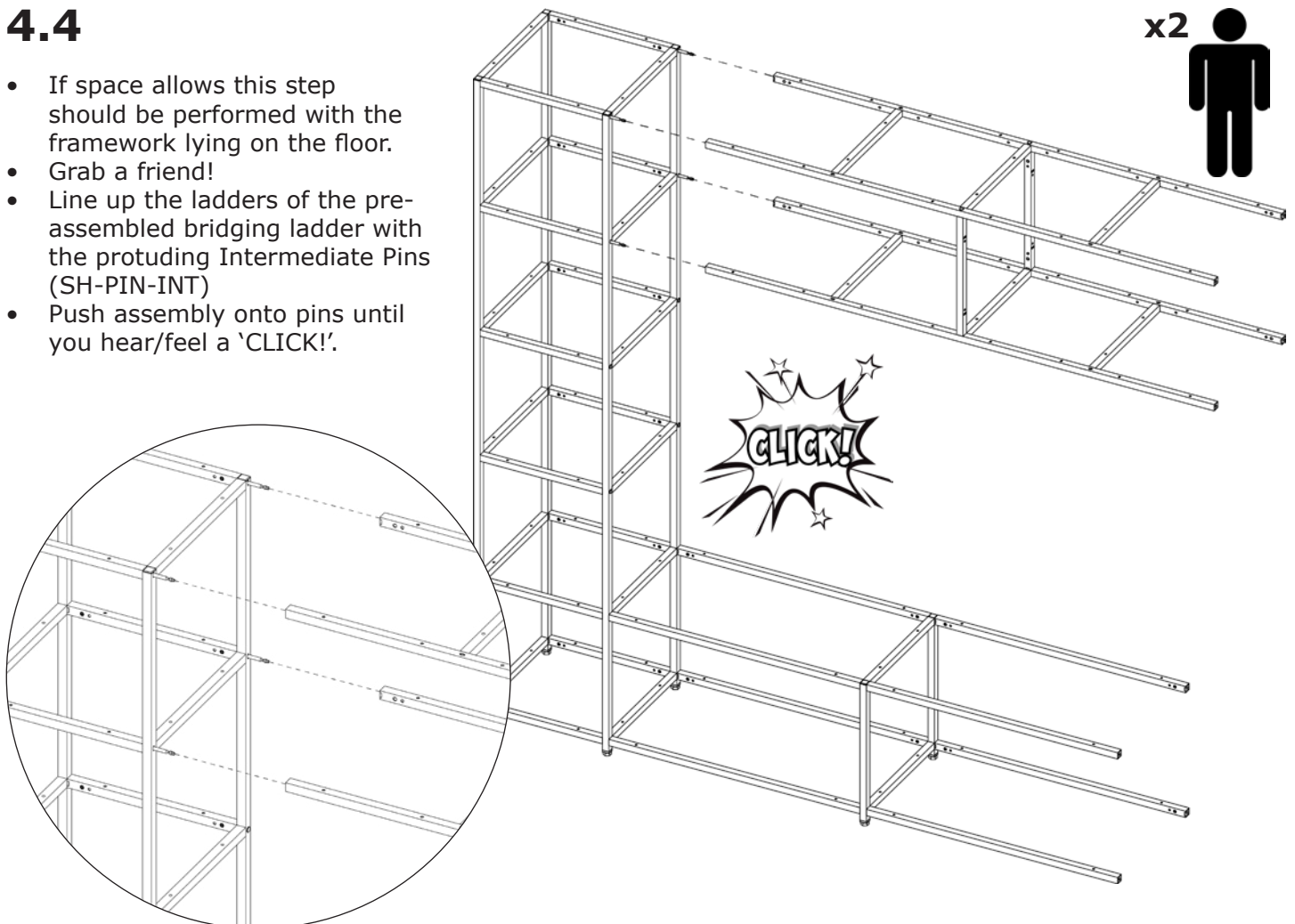

4.5

- Position the next ladder in place - this must be the same height or higher than the ladder already attached to the bridging ladder.
- Push the required pins (which pin to use is dependant on your specific configuration) through the holes in the ladder and into corresponding bridging ladder or rail until you hear/feel a 'CLICK!'.
- Repeat as required, this will support the bridging ladder temporarily whilst you continue with the build.

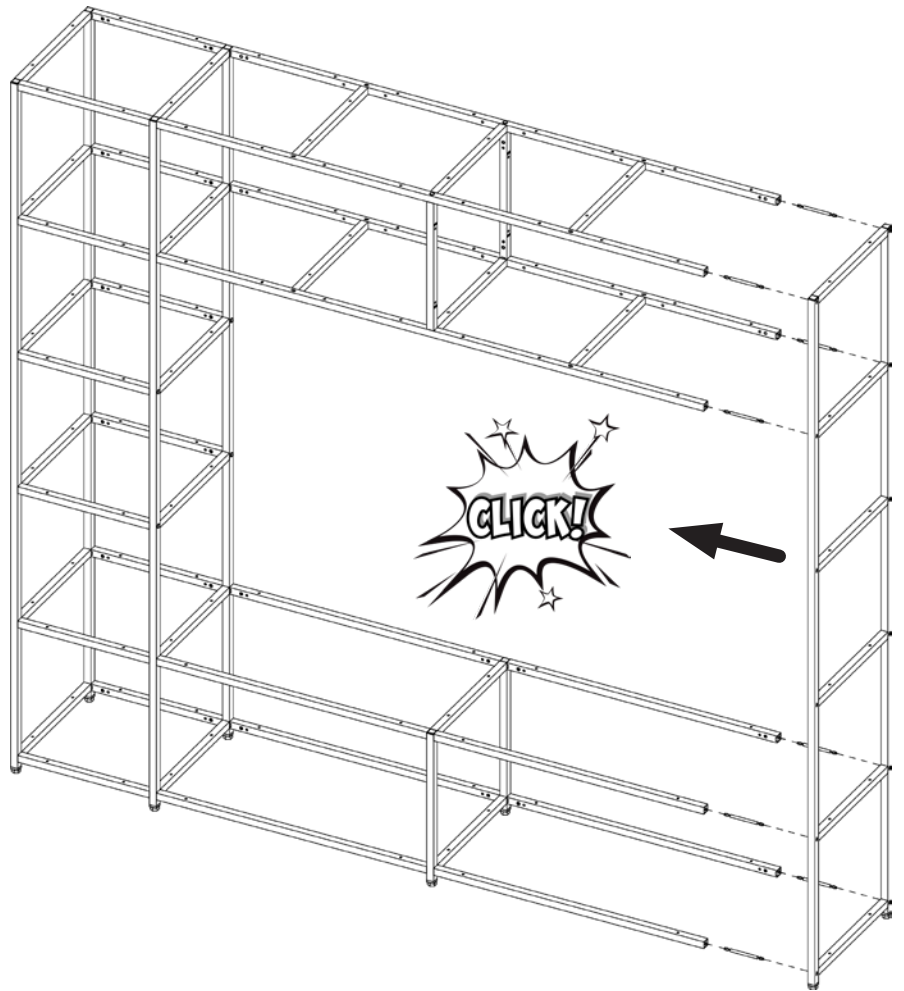

4.6

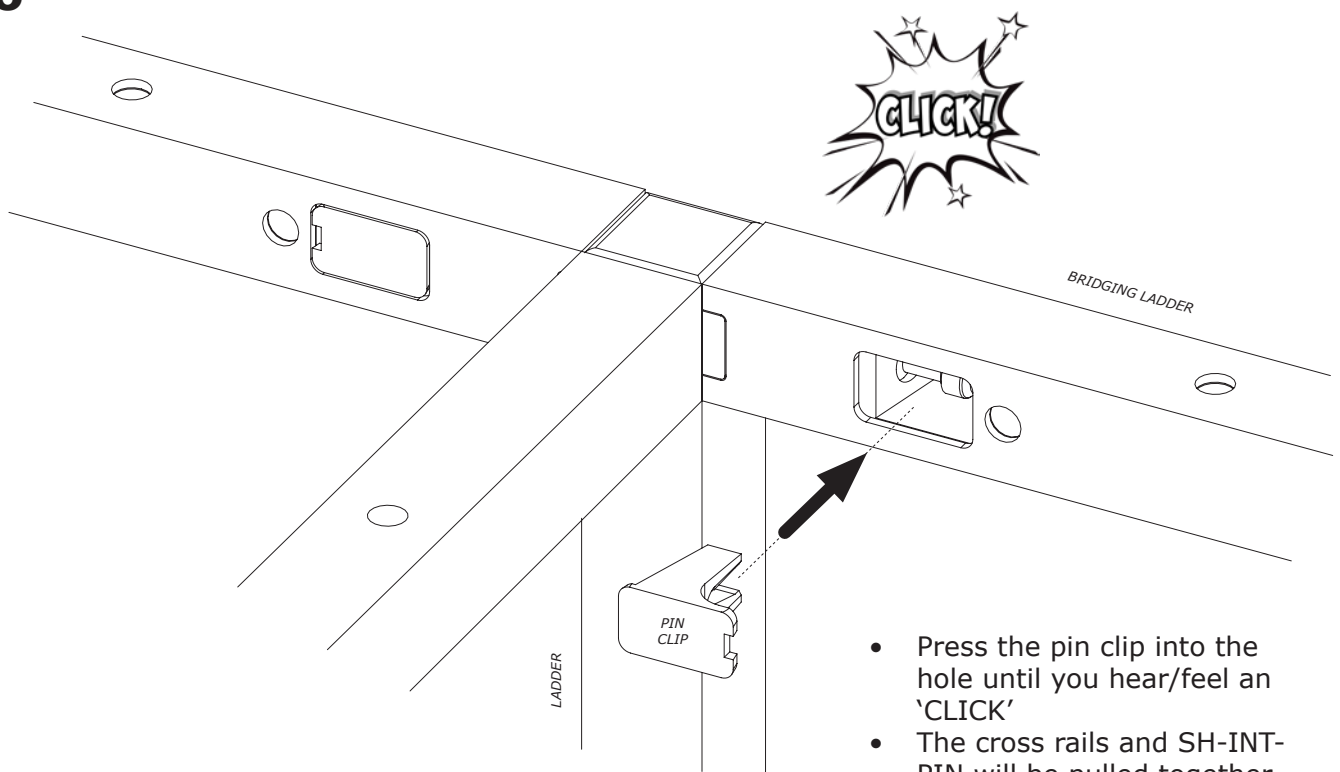

- Press the pin clip into the hole until you hear/feel an 'CLICK'
- The cross rails and SH-INT-PIN will be pulled together to create a rigid, stable joint around the ladder.
- Repeat as necessary for additional pin positions.
- Continue with the rest of the build as required.

5.1

- Position unit as required.
- Level using the adjustable feet in the end ladders and a spanner.

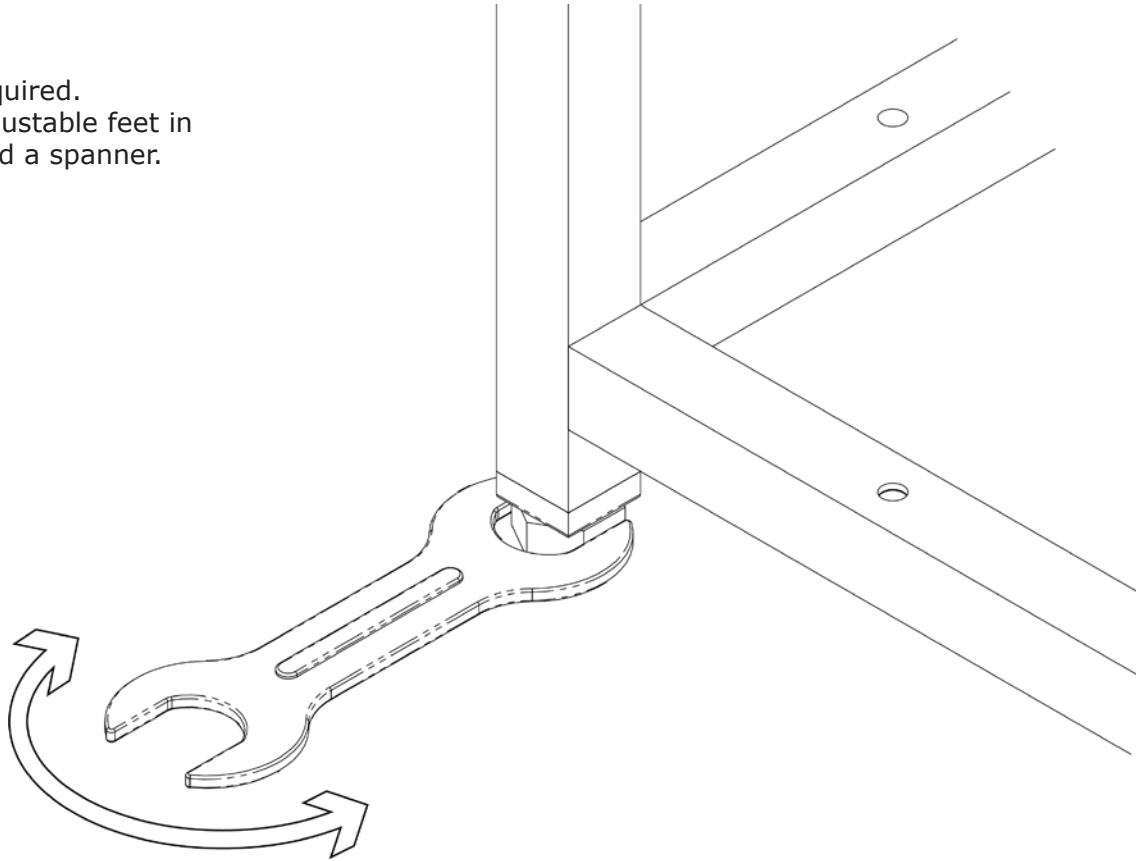

20mm Spanner



Spirit Level

Wall Fixing

6.1

- Attach wall fixing brackets to frame with M6x10mm Bolts.
- These should be installed as high as possible on the unit. Mark the wall positions using the brackets as a guide.
- The slot allows some vertical variance in the final hole position and allows additional levelling if required.

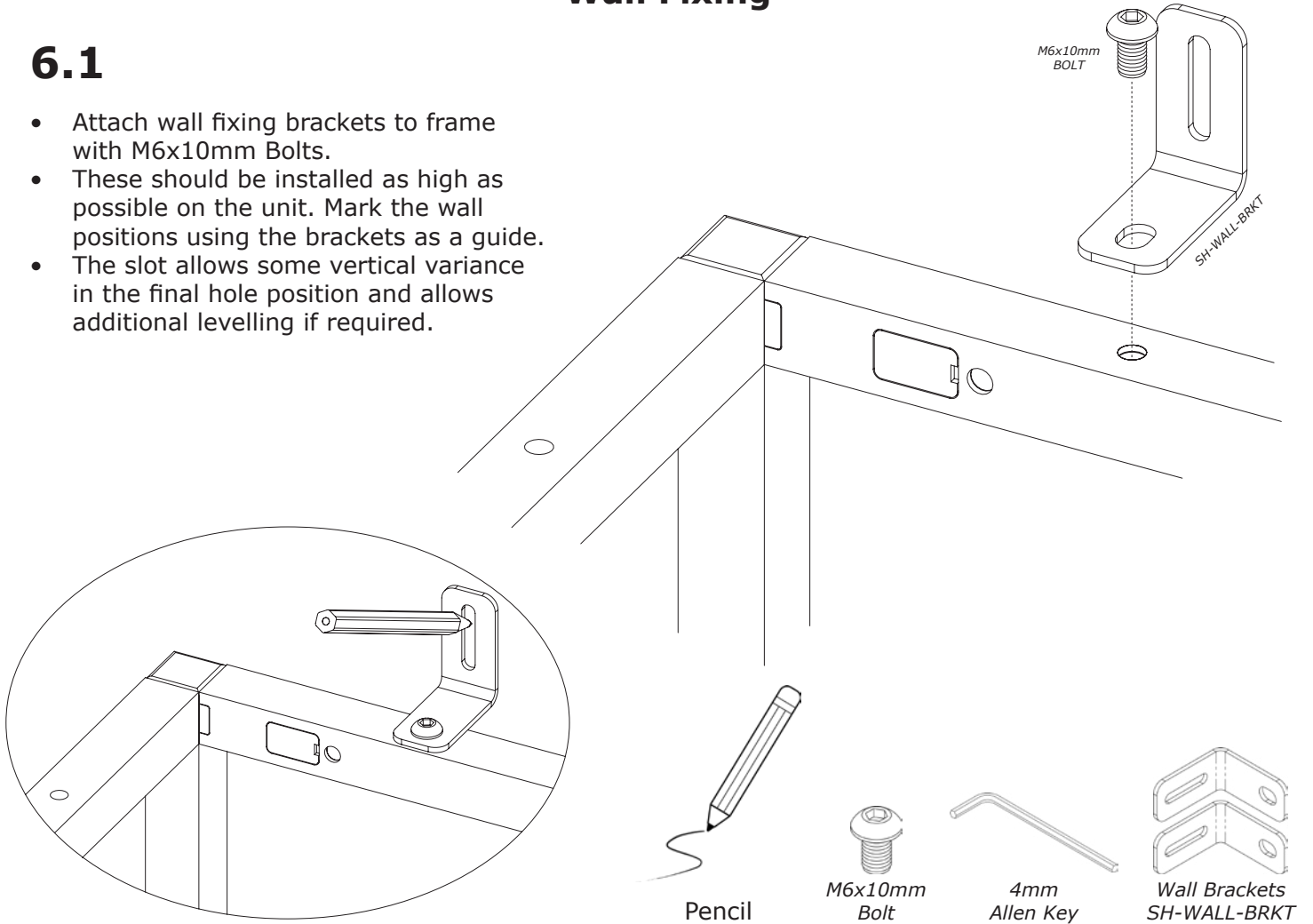

6.2

- Slacken bracket and rotate out of way.
- Drill the hole positions and insert suitable wall fixing.
- Secure unit to the wall.
- Ensure wall fixings suitable for the make up of the wall are used.
- PLEASE NOTE: THIS MAY NOT BE THOSE PROVIDED WITH THE BRACKETS
- Shelved accepts no responsibility for any damage caused by wall fixing furniture.

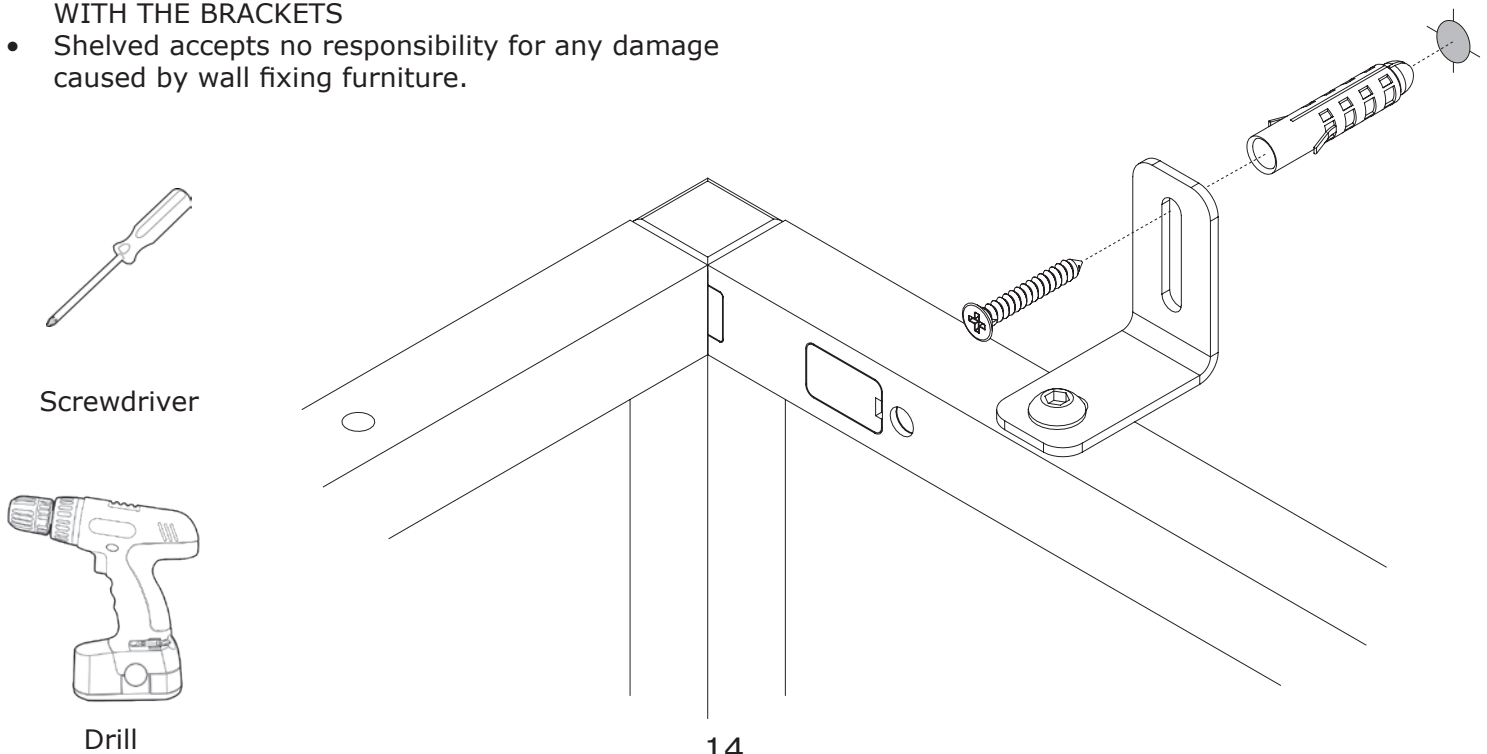

7.1

Removing clips and pins

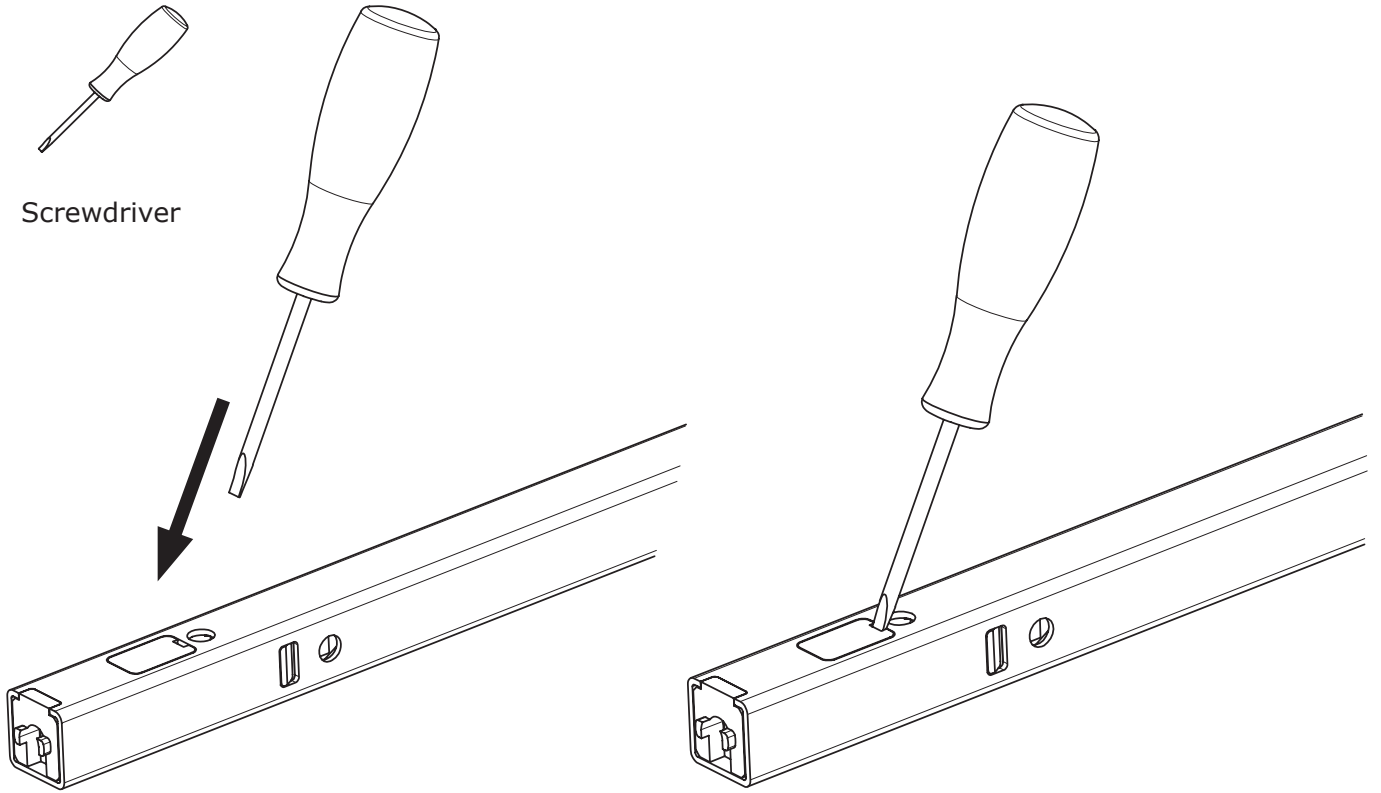

- To remove pin clips, following incorrect insertion or to re-configure your unit
- Insert a flathead screwdriver into the rectangular hole in the back edge of the pin clip as shown.

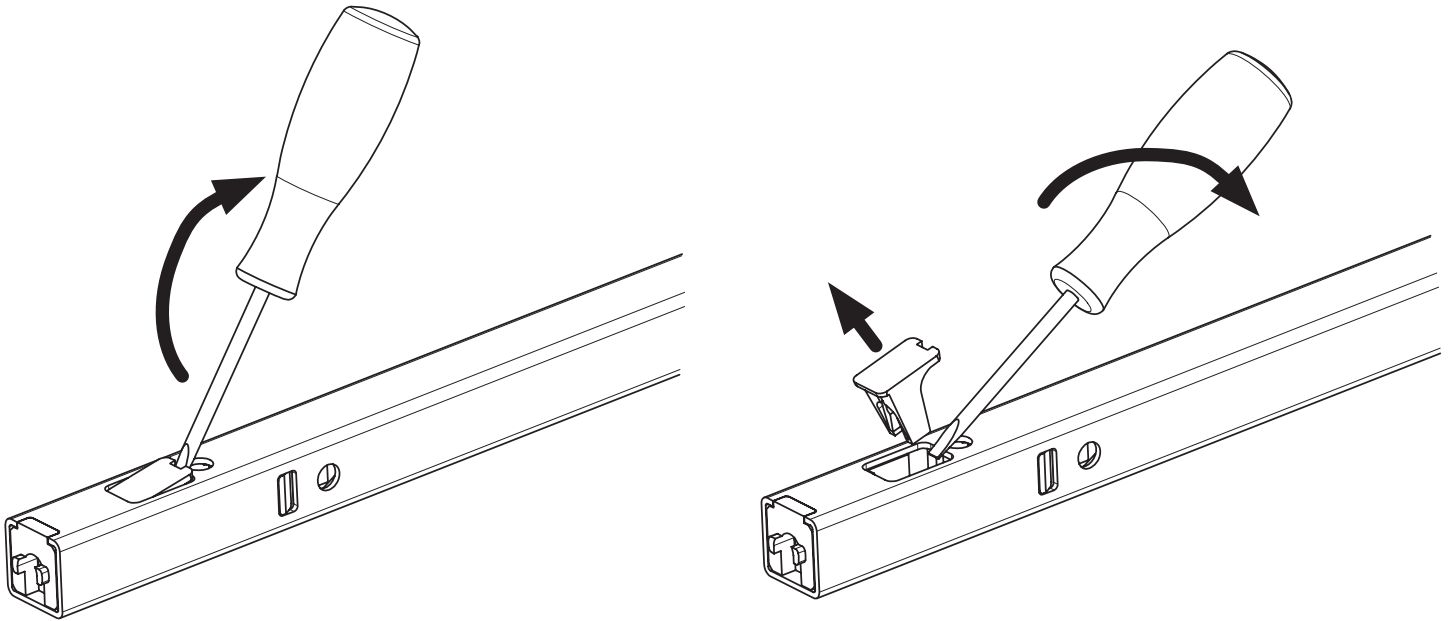

- Gently use the screwdriver to lever the pin clip out of the aperture in the rail by pushing backwards.
- Continue to level the screwdriver until the pin clip releases from the pin. You will then be able to remove the clip and pull the pin from the rail, dismantling the connection.

shelved®



Use the QR code to access the website directly from your mobile device.